

- Completed 345 kV line from Woodward to OKC
- FERC APPROVED PRIORITY TRANSMISSION PROJECTS**
- 1 Woodward to Hitchland, Texas: Double-circuit 345 kV line
- 2 Woodward to Medicine Lodge, Kansas: Double-circuit 345 kV line
- 3 Woodward - Tuco, Texas: 345 kV line
- 4 Valliant, Oklahoma to Texarkana (Texas-Arkansas border): 345 kV line

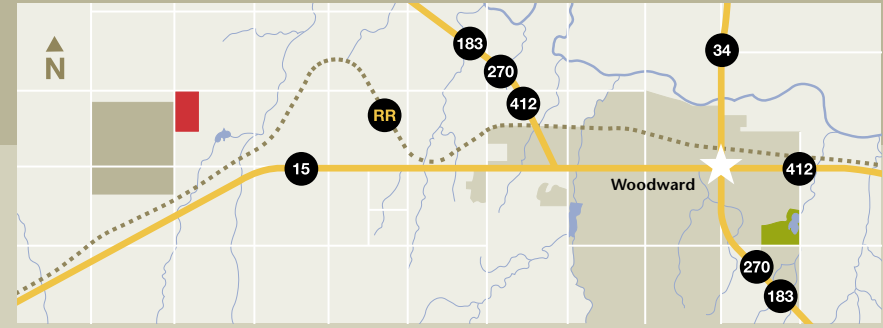

- Well maintained highway system for easy access
- Burlington Northern Santa Fe Railway spur
- 25-100 acre manufacturing sites with existing utilities
- Regional Airport / 720 acre Industrial Airpark
- Area Rivers and Lakes
- \$25 million parks improvement program
- Woodward: the leading Micropolitan in economic growth

*Located in the heart of Oklahoma's wind country, Woodward is leading the state in wind industry development. With a new high capacity transmission line, thousands of acres available for manufacturing and staging, easy access transportation, new training programs, an educated workforce, and strong economic growth, Woodward's initiatives have propelled the city to the vanguard of renewable energy.*